

Stutzen für Befüllereinrichtung oder Druckmeß- und Befüllereinrichtung, siehe Datenblatt Nr.: 10375

Connection for filling device or pressure-measuring and filling device, see data sheet No.: 10375

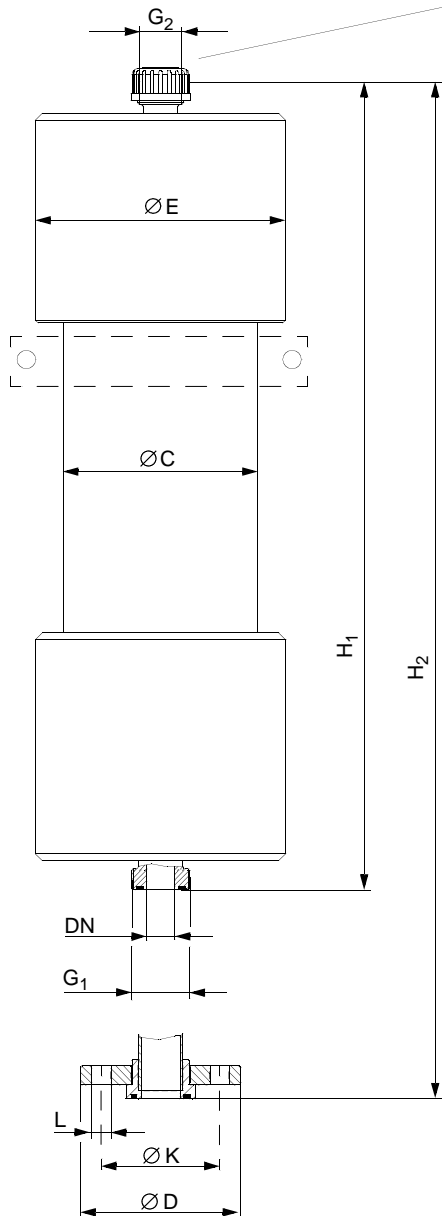

PVC-Ausführung
PVC-Execution

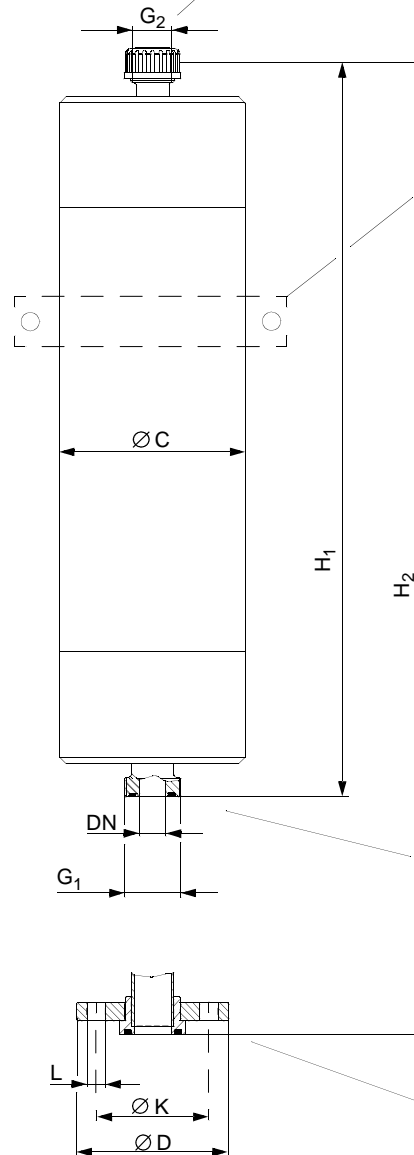

PP-Ausführung
PP-Execution

Befestigungsschellen
siehe Datenblatt Nr.: 10379

Fixing clamps
see data sheet No.: 10379

Gewindeanschluß
Thread connection

Losflansch
Loose flange

Pulsationsdämpfer

Pulsation damper

702.1, 703.1, 706.1

sera

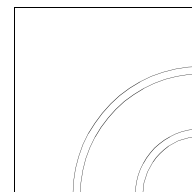
Dosieren
Fördern
Verdichten

Technische Daten / Technical data:

1. Gewindeanschluß / Thread connection:

| Typ Type | Artikel-Nr. Article-No. | Gehäuse Housing | Dichtungen Sealings | DN | Inhalt Contents (l) | G ₁ | G ₂ | H ₁ | C | | E | Leergewicht Empty weight (kg) |
|-------------|----------------------------|--------------------|------------------------|----|---------------------------|-------------------|----------------|----------------|------|-----|---|-------------------------------------|
| | | | | | | | | | (mm) | | | |
| 702.1 | 30095010 | PP | EPDM | 15 | 2 | G1 | G1 | 534 | 90 | 120 | | 1,4 |
| | 30095007 | | FPM | | | | | | | | | |
| | 30095004 | PVC | EPDM | | | | | 556 | | | | |
| | 30095001 | | FPM | | | | | | | | | |
| 703.1 | 30095011 | PP | EPDM | 20 | 5 | G1 ^{1/4} | G1 | 556 | 140 | 180 | | 3,2 |
| | 30095008 | | FPM | | | | | | | | | |
| | 30095005 | PVC | EPDM | | | | | 582 | | | | |
| | 30095002 | | FPM | | | | | | | | | |
| 706.1 | 30095012 | PP | EPDM | 40 | 10 | G2 ^{1/4} | G1 | 847 | 160 | 220 | | 6,2 |
| | 30095009 | | FPM | | | | | | | | | |
| | 30095006 | PVC | EPDM | | | | | 786 | | | | |
| | 30095003 | | FPM | | | | | | | | | |

2. Losflansch nach DIN 2501, PN 10 / Loose flange according to DIN 2501, PN 10

| Typ Type | Artikel-Nr. Article-No. | Gehäuse Housing | Dichtungen Sealings | DN | Inhalt Contents (l) | G ₂ | H ₂ | C | E | D | K | L | Leergewicht Empty weight (kg) | | | | |
|-------------|----------------------------|--------------------|------------------------|----|---------------------------|----------------|----------------|-----|-----|-----|-----|----|-------------------------------------|------|--|--|--|
| | | | | | | | | | | | | | | (mm) | | | |
| 702.1 | 30095022 | PP | EPDM | 15 | 2 | G1 | 570 | 90 | 120 | 95 | 65 | 14 | 1,5 | | | | |
| | 30095019 | | FPM | | | | | | | | | | | | | | |
| | 30095016 | PVC | EPDM | | | | | | | | | | 592 | | | | |
| | 30095013 | | FPM | | | | | | | | | | | | | | |
| 703.1 | 30095023 | PP | EPDM | 20 | 5 | G1 | 598 | 140 | 180 | 105 | 75 | 14 | 3,4 | | | | |
| | 30095020 | | FPM | | | | | | | | | | | | | | |
| | 30095017 | PVC | EPDM | | | | | | | | | | 614 | | | | |
| | 30095014 | | FPM | | | | | | | | | | | | | | |
| 706.1 | 30095024 | PP | EPDM | 40 | 10 | G1 | 869 | 160 | 220 | 150 | 110 | 18 | 6,4 | | | | |
| | 30095021 | | FPM | | | | | | | | | | | | | | |
| | 30095018 | PVC | EPDM | | | | | | | | | | 801 | | | | |
| | 30095015 | | FPM | | | | | | | | | | | | | | |

3. Betriebsbedingungen / Operating conditions

| Temperatur (für Wasser) Temperature (for water) (° C) | Zulässiger Betriebsdruck Max. permitted working pressure (bar) | |
|---|--|-----|
| | PP | PVC |
| 2°...20° C | 10 | 10 |
| 20°...30° C | 9 | 8 |
| 30°...40° C | 7 | 5 |

! Betriebsanleitung TA-162 beachten!
Adhere to operating instructions TA-162!

Mögliche Anschlußteile nach TA-15 / Possible connections as per data sheet TA-15.

Technische Änderungen vorbehalten.

Subject to technical modifications.